

12/4/2025  
R:\Projects\23-070.0\W-5805G\Updated Files\Roadway\W-5805G\_Rdy\_psh4\_TCP\_1.dgn  
User:Kassy.martinez

REVISIONS

8/17/99

**LEGEND**

NEW TEMPORARY MARKINGS

EXISTING MARKINGS (GRAY)

NEW CONSTRUCTION AREAS

NOTE: MAINTAIN DRIVEWAY ACCESS WHILE UNDER CONSTRUCTION.

NOTE: ALL LANE WIDTHS ARE 12' UNLESS OTHERWISE SHOWN.

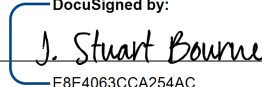

ICE of Carolinas, PLLC  
4505 Falls of Neuse Road, Suite 110  
Raleigh, North Carolina 27609  
Phone: 803-822-0333  
License #: P-0999

APPROVED:   
DATE: 12/4/2025

SEAL

DOCUMENT NOT CONSIDERED FINAL  
UNLESS ALL SIGNATURES COMPLETED

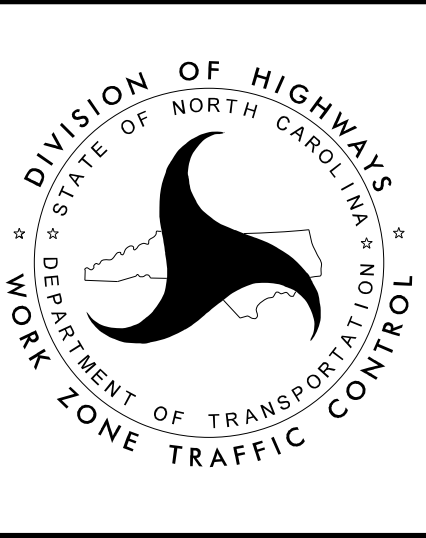

TEMPORARY TRAFFIC  
CONTROL  
PHASE I DETAIL

USING ROADWAY STANDARD DRAWING  
1101.01 SHEET 2 OF 3, ERECT WORK  
ZONE ADVANCED WARNING SIGNS ON  
US 1.

USING ROADWAY STANDARD DRAWING  
1101.02 SHEET 3 OF 19,CLOSE THE  
RIGHT LANE FOR NB US 1.

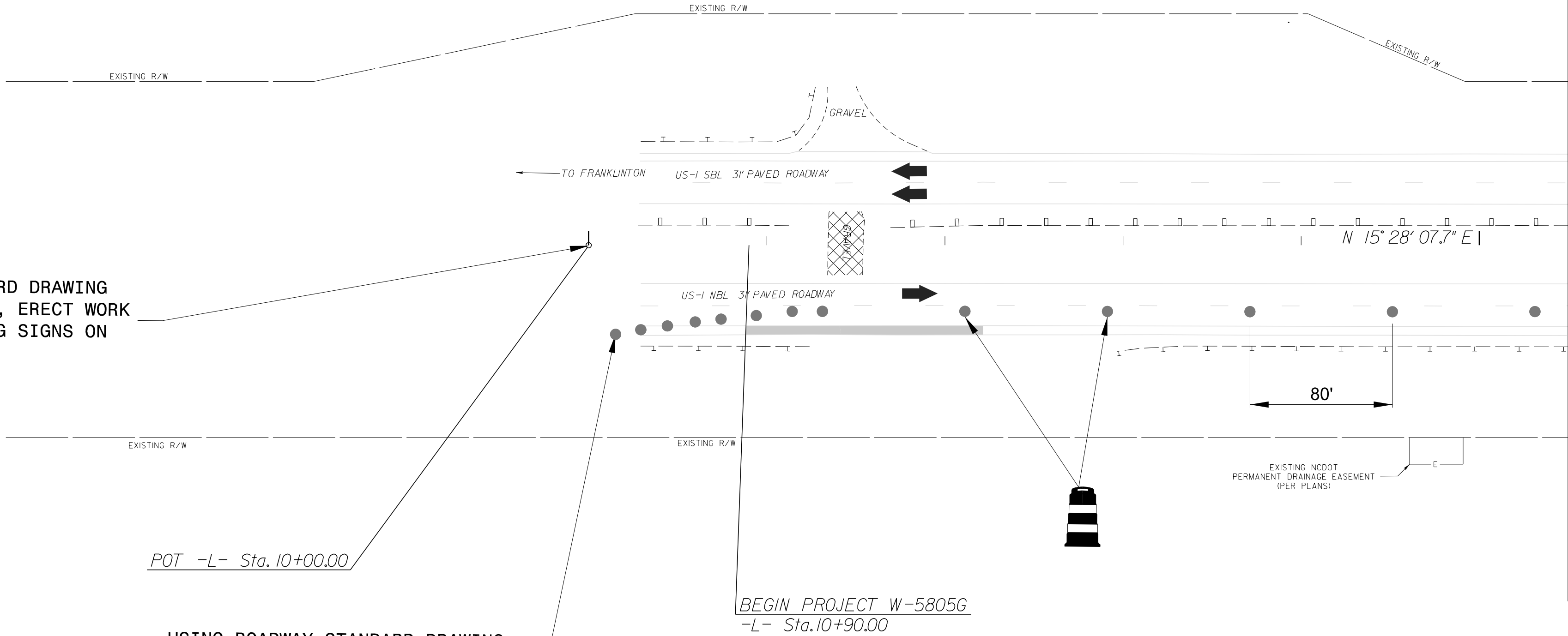

NAD 83/2011

PROJ. REFERENCE NO.	SHEET NO.
W-5805G	TMP-04